



Quick Installation Guide

Wi-Fi 6 Router

RX12L/TX12L/RX12L Pro/TX12L Pro/

RX2L/TX2L/RX2L Pro/TX2L Pro

Package Contents

- Wireless router x 1
- Power adapter x 1
- Ethernet cable x 1
- Quick installation guide

RX12L Pro is used for illustrations here unless otherwise specified. The actual product prevails.

Scenario 1: Set up the Device as a Router

I. Connect the Router

The product appearance may vary with models. Please refer to the product you purchased.

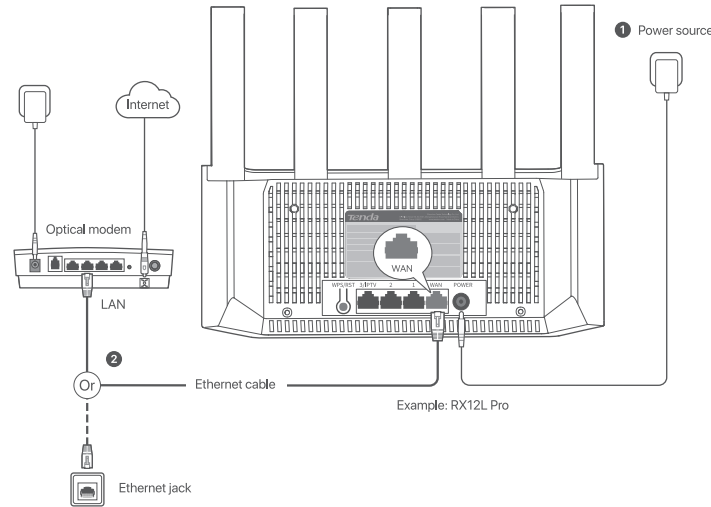

Tips

- If you use the modem for internet access, power off the modem first before connecting the WAN port of the router to the LAN port of your modem and power it on after the connection.
- Refer to the following relocation tips to locate the router to a proper position:
 - Place the router in a high position with few obstacles.
 - Unfold the antenna of the router vertically.
 - Keep your router away from electronics with strong interference, such as microwave ovens, induction cookers, and refrigerators.
 - Keep your router away from metal barriers, such as weak current boxes, and metal frames.

- 1 Power on the router.
- 2 Connect the WAN port of the router to the LAN port of your modem or the Ethernet jack using an Ethernet cable.

II. Connect the Router to the Internet

1. Connect your wireless client such as a smartphone to the WiFi network of the router, or use an Ethernet cable to connect the computer to the LAN port of the router. The WiFi name can be found on the label of the router's body.
2. After the client connects to the router, the page will automatically redirect to the web UI of the router. If not, start a web browser on your client and enter **tendawifi.com** in the address bar to access the router's web UI.

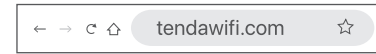

3. Perform operations as prompted (smartphone used as an example).

- 1 Tap Start.



- 2 The router detects your connection type automatically.

- If your internet access is available without further configuration (for example, PPPoE connection through an optical modem is completed), tap **Next**.

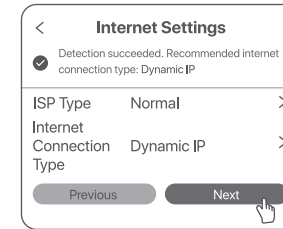

- If the PPPoE user name and password are required for internet access, select the **ISP Type** based on your region and ISP and enter required parameters (if any). If you forget your PPPoE user name and password, you can obtain the PPPoE user name and password from your ISP and manually enter them. Then, tap **Next**.

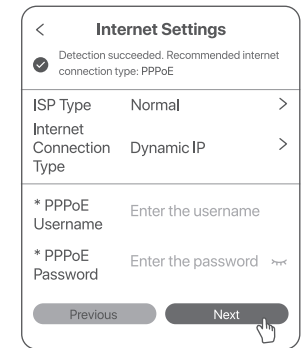

- 3 Set the WiFi name, WiFi password and login password for the router. Tap **Next**.

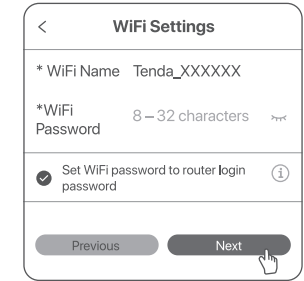

Tips

The WiFi password is used to connect to the WiFi network, while the login password is used to log in to the web UI of the router.

Scenario 2: Set Up as an Add-on Node



Tips

- This router can be networked with **Tenda WiFi+** routers.
- Ensure that the existing router (primary node) has been connected to the internet and the router (secondary node) to be added has never been used. If not, reset this router first.
- Two RX12L Pro are used as an example here. If the router fails to be added to an existing network, contact Tenda customer service for help.

I. Add the Router to an Existing Network

1. Place the router in an elevated and open position within 3 meters from your existing router.
2. Use the power adapter to connect the router to a power source.
3. Press the **WPS** button of the router for about 1-3 seconds. The LED indicator blinks green quickly. Within 2 minutes, press the **WPS** button of the existing router for 1-3 seconds to negotiate with this router.

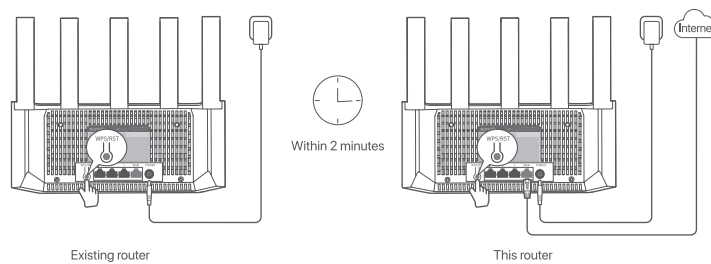

When the LED indicator of the router lights solid green, the networking is successful and the router becomes a secondary node in the network.

II. Relocate the Router

1. Refer to the following relocation tips to locate the router to a proper position:
 - Ensure that the distance between any two nodes is less than 10 meters.
 - Keep your routers away from electronics with strong interference, such as microwave ovens, induction cookers, and refrigerators.
 - Place the routers in a high position with few obstacles.
2. Power on the router again.
3. Wait 1-2 minutes and observe the router's LED indicator. If the LED indicator is solid green, the connection between the primary node and secondary node is good. Otherwise, move the router (secondary node) closer to the existing router for better connection quality.

- 1 Done.

To access the internet with:

- WiFi-enabled devices: Connect to your WiFi network. (The WiFi name and WiFi password of the new router are the same as the existing router.)
- Wired devices: Connect to a LAN port of the router using an Ethernet cable.

LED Indicator

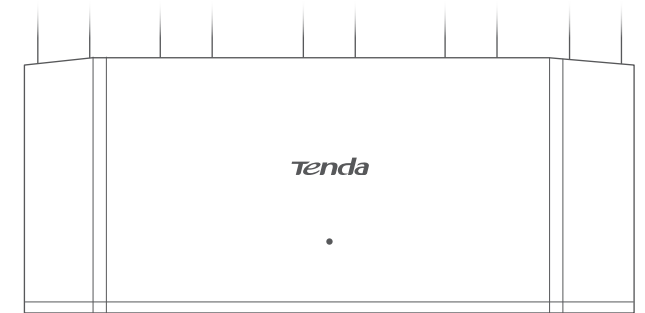

Example: RX12L Pro

LED indicator	Scenario	Status	Description	
LED indicator	Startup	Solid green	The system is starting up.	
		Solid green	The router is connected to the internet.	
	Internet connection	Primary node	Blinking green slowly	Not configured and the router is not connected to the internet.
			Blinking red slowly	Configured but the router failed to connect to the internet.
			Blinking orange slowly	Configured but no Ethernet cable is connected to the WAN port.
		Secondary node	Solid green	Networking succeeds. Good connection quality.
			Solid orange	Networking succeeds. Fair connection quality.
			Solid red	Networking succeeds. Poor connection quality.
	LED indicator		Blinking green slowly	Waiting to connect to another node.
			Blinking red slowly	Configured but the router failed to connect to the internet.
		WPS	Blinking green quickly	Pending for or performing WPS negotiation (valid within 2 minutes)
			Blinking green quickly for 3 seconds	A device is connected to or disconnected from an Ethernet port of the router.
		PPPoE user name and password importing (only for primary node)	Blinking green quickly for 8 seconds	PPPoE user name and password are imported successfully.
			Resetting	Blinking orange quickly

- 1 Done. When the LED indicator is solid green, the network connection is successful.

To access the internet with:

- WiFi-enabled devices: Connect to the WiFi network using WiFi name and password you set.
- Wired devices: Connect to a LAN port of the router using an Ethernet cable.



Tips

If you want to manage the router anytime, anywhere, scan the QR code to download the Tenda WiFi app, register and log in.



Download Tenda WiFi App

Get Support and Services

For technical specifications, user guides and more information, please visit the product page or service page on www.tendacn.com. Multiple languages are available. You can see the product name and model on the product label.



<https://www.tendacn.com/service/default.html>

